

Glass Sash Removal

©2013 202220684 5/13

Retract finger pulls of the operating sash. Slide the glass up until the finger pulls line up with the notch.

With the finger pulls still compressed, pull the bottom of the sash toward you and through the notch, removing it from the track. Tilt and rotate sash to remove.

Tip: you can watch a video at LARSONdoors.com/videos

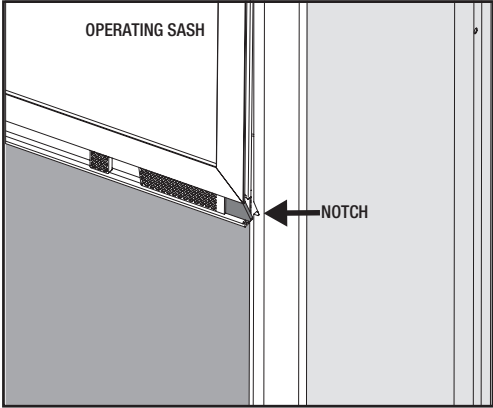
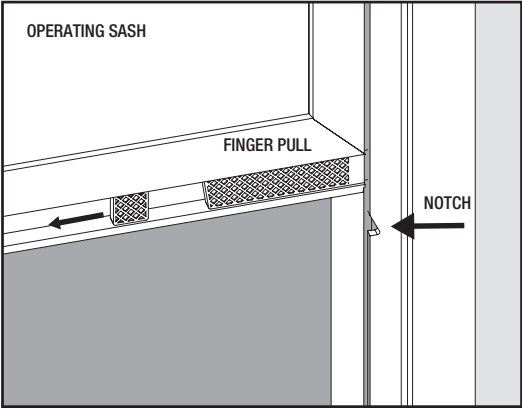

INSIDE VIEW

Glass Sash Removal

©2013 202220684 5/13

Retract finger pulls of the operating sash. Slide the glass up until the finger pulls line up with the notch.

With the finger pulls still compressed, pull the bottom of the sash toward you and through the notch, removing it from the track. Tilt and rotate sash to remove.

Tip: you can watch a video at LARSONdoors.com/videos

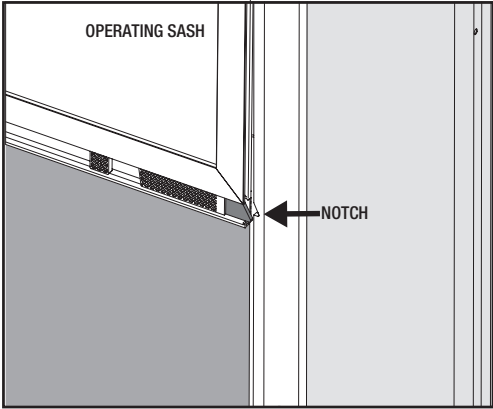
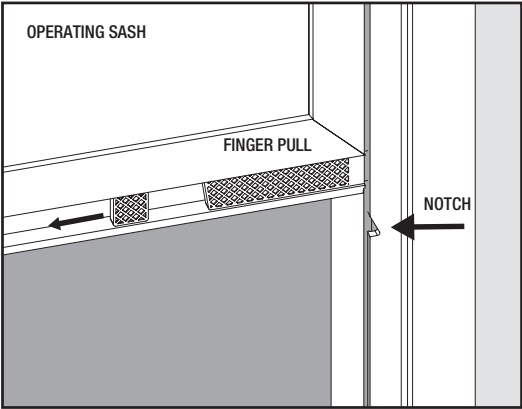

INSIDE VIEW

Glass Sash Removal

©2013 202220684 5/13

Retract finger pulls of the operating sash. Slide the glass up until the finger pulls line up with the notch.

With the finger pulls still compressed, pull the bottom of the sash toward you and through the notch, removing it from the track. Tilt and rotate sash to remove.

Tip: you can watch a video at LARSONdoors.com/videos

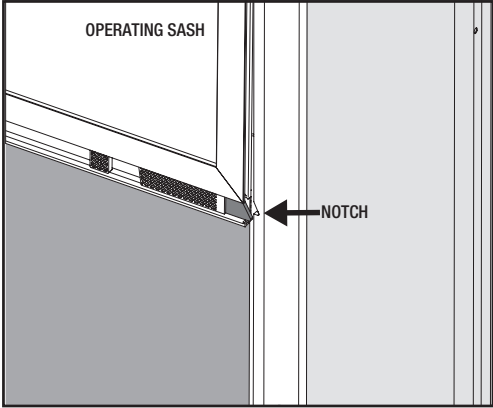
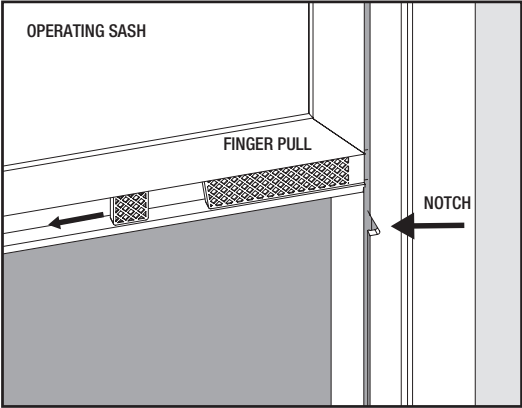

INSIDE VIEW